

## ISTRUZIONI FOR USE OF HLS – HS STRAIGHT AND CURVED RAMPS

### General information

This range of products has been manufactured for all users who need to combine good loading capacity with a lightweight, easy to handle product **for a non- professional and non-regular use but for DIY / hobby applications.**

The purchased product must only be utilized for the purposes expressly indicated by the manufacturer, in particular:

- Always respect the requirements / indications below contained
- Do not utilize the product if it has not been correctly installed and positioned for proper use
- Do not overload the ramps beyond the loading capacity limits indicated by the manufacturer (in order to ensure proper use, it should be noted that the purchased product's technical data are listed on the data plate affixed to the product itself)
- Do not use the purchased as a table or chair, or as a means for climbing or overcoming vertical barriers
- **We recommend that gloves are always used when working with the ramps**
- The ramps must never be use has a bridge
- No person is allowed underneath the ramps as long as they are being used
- The slope of the ramps during use may not exceed a maximum of 30%, which is equal to 16,5°, as there is a risk for tipping of the vehicle.

### Wheel width

The maximum width of the wheel is the width of the running surface of the ramp less 20 mm.

Full-track vehicles must not be used.

### Load distribution

The ramps must be used taking into account the distribution of the weights on the axles of the vehicle that will be transiting upon them. The heaviest axle must always be the one at the highest point.

### Acceleration and braking

It is forbidden to perform any sudden acceleration or braking maneuvers that could lead to instability during use, as this could result in personal injuries or property damage, also this could influence the ramps dynamically and thus increase the load considerably.

### Mounting and securing of ramps during loading / unloading

The ramps must be correctly mounted to the vehicle; **the head connection MUST be completely placed against the loading bed.**

Position the ramps parallel with one another and perpendicular to the loading bed. Check to make sure that the wheelbase between the ramps corresponds to the wheelbase between the vehicle's wheels.

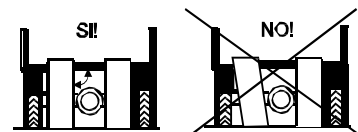

Always climb by keeping the straight line.

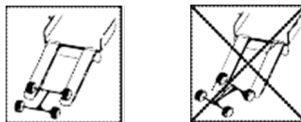

Always climb at the center of the ramps.

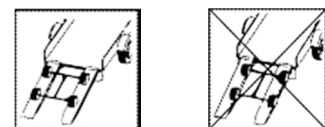

To ensure that the ramps will not move during loading and unloading activities, it is essential to use the appropriate aluminium bracket purchased separately and to be fastened to the ramps using the appropriate bolts and washers.

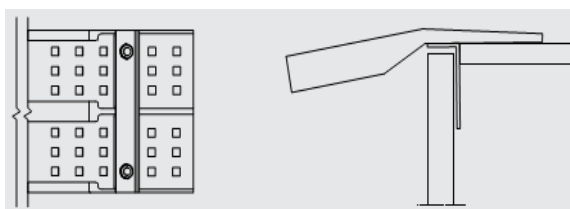



## MANUFACTURER'S DECLARATION OF CONFORMITY

(pursuant to UNI CEI EN ISO/IEC 17050-1)

The Undersigned company **METALMEC S.r.l.** with registered office at:  
Via San Cassiano, 6 – 24030 Mapello (BG) - Italia

**HEREBY DECLARES, IN ITS CAPACITY AS THE MANUFACTURER, AND UNDER ITS OWN RESPONSIBILITY, THAT THE FOLLOWING PRODUCT:**

**Commercial denomination: Loading ramps in aluminium alloy 6005A**

**Models: HLS – HS straight and curved**

**Has been designed, built and tested in accordance with the following technical standards applied by the manufacturer:**

- EN 1090-3 – Execution of steel structures and aluminium structures - Part 3: Technical requirements for aluminium structures
- EN 1999-1-1 - Eurocode 9 – Design of aluminium structures - Part 1-1: General structural rules.
- EN ISO 15613 – Specification and qualification of welding procedures for metallic materials – Qualification based on pre-production welding test
- EN ISO 15614-2 - Specification and qualification of welding procedures for metallic materials – Welding procedure test - Part 2: Arc welding of aluminium and its alloys
- EN 1398:2009 - Dock levellers – Safety requirements.

### the manufacturer also DECLARES

That the buyer is responsible for the proper use of the product purchased in accordance with its intended use and the indications contained in the instructions for use.

It is forbidden to make changes of any kind and / or in any measure to the product purchased.

The manufacturer shall bear no direct and / or indirect responsibility for the improper use of the product or any use of the product to purposes other than those expressly indicated by the manufacturer.

The model, capacity, date of manufacture and serial number are indicated on the manufacturer's identification plate affixed to the product, which contains the data listed below based on the type of ramp purchased:

	<b>LOADING RAMP</b>	<b>MODEL:</b>
	<b>RAMP WEIGHT:</b> <b>INDIVIDUAL CAPACITY:</b> <b>PAIR CAPACITY:</b> <b>DATE OF MANUFACTURE:</b> <b>MANUFACTURER: METALMEC S.r.l. Via S. Cassiano 6 Mapello 24030 (BG) Italy</b>	<b>SERIAL NR.:</b>

All the products furnished by Metalmec S.r.l. are inspected and tested according to the safety coefficients required by the reference standards.

The technical documentation regarding the product is held by **Metalmec S.r.l.** in its capacity as a legal entity - Via San Cassiano, 6 – 24030 Mapello (BG) - Italia.